

CIRCULATIA TERENURILOR	suprafata	
	mp	%
Suprafata parcela existenta	69.020	100
Suprafata de reparcelat	51.992	73,68
Suprafata ce trece in domeniul public	17.028	26,68

SUPRAFATA DE TEREN	existent		propus	
	mp	%	mp	%
Total parcela studiata	69.020	100	69.020	100
Locuinte	-	-	47.545	68,88
Circulatii	carosabil	-	8.763	12,69
	trotuare	-	2.671	3,86
Total circulatii	-	-	11.434	16,55
Spatii verzi de aliniament	-	-	1.458	2,69
Parc	-	-	5.594	8,10
Gradini	-	-	2.964	3,75
Dotari	-	-	25	0,03

s.c. PRO ARHI LINE s.r.l.				Proiect: <b>PLAN URBANISTIC ZONAL</b>	Proiect nr. : 14/2001
				Loc. proiect: Localitatea DUMBRAVITA, jud. TIMIS	
				Beneficiar: BERCEA, BALINTONI, PAPP MANDAK, NEMEDI, PURTATOR	Faza: <b>P. U. Z.</b>
Sef proiect: arh. L. Buzulica		Scara:	Plansa: <b>Bilant teritorial</b>	Plansa nr. : <b>A 06</b>	
Proiectat: arh. M. Catana		Data: sept. 2001			
Desenat: arh. F. Blidar					

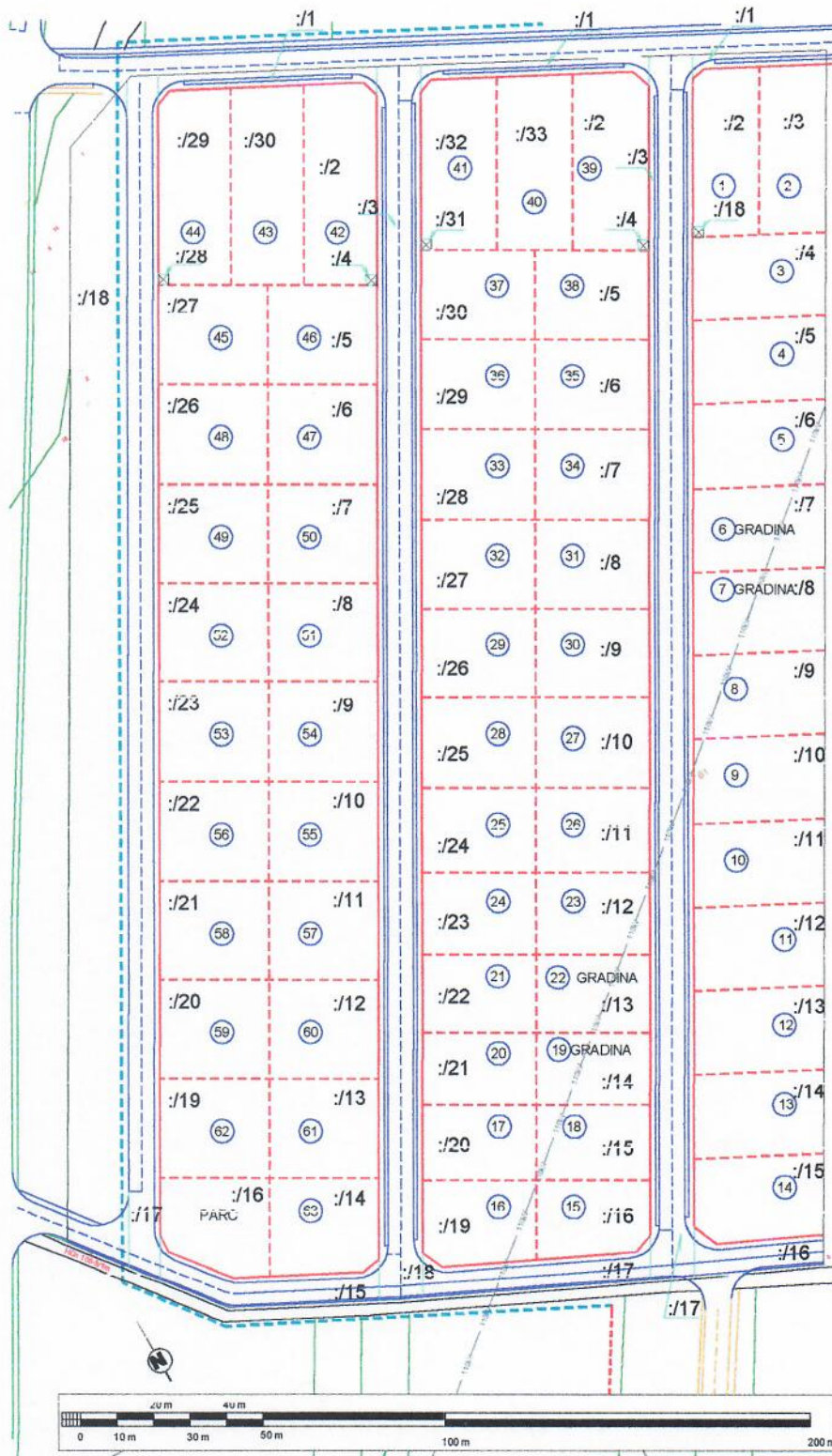

# PLAN URBANISTIC ZONAL

## LEGENDA Delimitari

- Limita topo teren
- Limita parcele propuse
- Limita intravilan propus
- Limita proprietati

## Simboluri

- Cladiri existente
- Numar parcela
- Nr topo propus
- Linie L.E.A. 110 kv
- Stilpi de curent
- Drumuri propuse
- Drumuri existente
- Limita perdea de protectie
- Tanc septic

s.c. PRO ARHI LINE s.r.l.



Proiect: **PLAN URBANISTIC ZONAL**  
 Loc. proiect: Localitatea DUMBRAVITA, jud. TIMIS  
 Beneficiar: BERCEA, BALINTONI, PAPP MANDAK, NEMEDI, PURTATOR

Proiect nr. : 14/2001

Sef proiect: arh. L. Buzulica  
 Proiectat: arh. M. Catana  
 Desenat: arh. F. Blidar

Scara: 1:2000  
 Data: sept.2001

Planşa: **Numerotare topografica**

Faza: **P. U. Z.**  
 Planşa nr. : **A 07**

A. SITUATIA CONFORM CARTII FUNCIARE, INAINTE DE DEZMEMBRARE

Nr. crt.	Nr. CF.	Nr. topo.	Suprafata		Descriere	Cota Parte	Proprietar
			ha	mp			
1	1583	246/b/1/1/2; 246/b/1/2/2; 246/b/2/2; 246/a/1/2; 246/a/2/2/9;	1	4000	Arabil	5/7 2/7	Bercia Valer Balintoni Silvia

B. Situatia dupa dezmembrare,  
intabulare si rectificare CF

Nr. crt.	Nr. topografic nou	Nr. parcela
1	<u>246/b/1/1/2;246/b/1/2/2;246/b/2/2;246/a/1/2;246/a/2/2/9</u> 1	acces drum
2	<u>246/b/1/1/2;246/b/1/2/2;246/b/2/2;246/a/1/2;246/a/2/2/9</u> 2	1
3	<u>246/b/1/1/2;246/b/1/2/2;246/b/2/2;246/a/1/2;246/a/2/2/9</u> 3	2
4	<u>246/b/1/1/2;246/b/1/2/2;246/b/2/2;246/a/1/2;246/a/2/2/9</u> 4	3
5	<u>246/b/1/1/2;246/b/1/2/2;246/b/2/2;246/a/1/2;246/a/2/2/9</u> 5	4
6	<u>246/b/1/1/2;246/b/1/2/2;246/b/2/2;246/a/1/2;246/a/2/2/9</u> 6	5
7	<u>246/b/1/1/2;246/b/1/2/2;246/b/2/2;246/a/1/2;246/a/2/2/9</u> 7	6
8	<u>246/b/1/1/2;246/b/1/2/2;246/b/2/2;246/a/1/2;246/a/2/2/9</u> 8	7
9	<u>246/b/1/1/2;246/b/1/2/2;246/b/2/2;246/a/1/2;246/a/2/2/9</u> 9	8
10	<u>246/b/1/1/2;246/b/1/2/2;246/b/2/2;246/a/1/2;246/a/2/2/9</u> 10	9
11	<u>246/b/1/1/2;246/b/1/2/2;246/b/2/2;246/a/1/2;246/a/2/2/9</u> 11	10
12	<u>246/b/1/1/2;246/b/1/2/2;246/b/2/2;246/a/1/2;246/a/2/2/9</u> 12	11
13	<u>246/b/1/1/2;246/b/1/2/2;246/b/2/2;246/a/1/2;246/a/2/2/9</u> 13	12
14	<u>246/b/1/1/2;246/b/1/2/2;246/b/2/2;246/a/1/2;246/a/2/2/9</u> 14	13
15	<u>246/b/1/1/2;246/b/1/2/2;246/b/2/2;246/a/1/2;246/a/2/2/9</u> 15	14
16	<u>246/b/1/1/2;246/b/1/2/2;246/b/2/2;246/a/1/2;246/a/2/2/9</u> 16	drum
17	<u>246/b/1/1/2;246/b/1/2/2;246/b/2/2;246/a/1/2;246/a/2/2/9</u> 17	drum
18	<u>246/b/1/1/2;246/b/1/2/2;246/b/2/2;246/a/1/2;246/a/2/2/9</u> 18	tanc septic

s.c. PRO ARHI LINE s.r.l.				Proiect: <b>PLAN URBANISTIC ZONAL</b>	Proiect nr. : 14/2001
				Loc. proiect: Localitatea DUMBRAVITA, jud. TIMIS	Faza: <b>P. U. Z.</b>
Sef proiect: arh. L. Buzulica	 	Scara: 1:2000	Beneficiar: BERCEA, BALINTONI, PAPP MANDAK, NEMEDI, PURTATOR	Plansa nr. : <b>A 08</b>	
Proiectat: arh. M. Catana		Data: sept.2001	Plansa: <b>Situatia topografica BERCIA - BALINTONI</b>		
Desenat: arh. F. Blidar					

A. SITUATIA CONFORM CARTII FUNCIARE, INAINTE DE DEZMEMBRARE

Nr. crt.	Nr. CF.	Nr. topo.	Suprafata		Descriere	Cota Parte	Proprietar
			ha	mp			
2	1581	246/b/1/1/2; 246/b/1/2/2; 246/b/2/2; 246/a/1/2; 246/a/2/2/7 246/b/1/1/2; etc. 246/a/2/2/8	- -	773 2477	Arabil Arabil	1/1	Pap Stefan
3	1575	246/b/1/1/2; etc. 246/a/2/2/6	-	1750	Arabil	1/1	Mandak Terezia
4	1582	246/b/1/2; 246/b/1/2/2; 246/b/2/2; 246/a/1/2; 246/a/2/2/4 246/b/1/1/2; etc. 246/a/2/2/5	- 1	975 9025	Arabil Arabil	1/1	Nemedi Emeric

B. Situatiua dupa dezmembrare, intabulare si rectificare CF

Nr. crt.	Nr. topografic nou	Nr. parcela
1	246/b/1/1/2;246/b/1/2/2;246/b/2/2;246/a/1/2;246/a/2/2/7; 246/b/1/1/2;246/b/1/8;246/b/1/1/2;246/a/2/2/6;246/b/1/1/2; 246/b/1/2/2;246/b/2/2;246/a/1/2;246/a/2/2/4; 246/b/1/1/2;246/a/2/2/5	acces drum :/1
2		:/2 39
3		:/3 acces drum
4		:/4 tanc septic
5		:/5 38
6		:/6 35
7		:/7 34
8		:/8 31
9		:/9 30
10		:/10 27
11		:/11 26
12		:/12 23
13		:/13 22
14		:/14 19
15		:/15 18
16		:/16 15
17		:/17 drum
18		:/18 drum

Proiect nr. :	14/2001	Faza:	P. U. Z.	Plansa nr. :	A 09
Proiect:	PLAN URBANISTIC ZONAL	Beneficiar:	BERCEA, BALINTONI, PAPP MANDAK, NEMEDI, PURTATOR	Plansa:	
Loc. proiect:	Localitatea DUMBRAVITA, jud. TIMIS			Situatiua topografica NEMEDI -PAPP - MANDAK	
Scara:	1:2000	Data:	sept.2001		
Sef proiect:	arh. L. Buzulica				
Proiectat:	arh. M. Catana				
Desenat:	arh. F. Blidar				
	arh. F. Blidar				

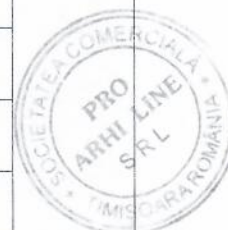

s.c. PRO ARHI LINE s.r.l.

A. SITUATIA CONFORM CARTII FUNCIARE, INAINTE DE DEZMEMBRARE

Nr. crt.	Nr. CF.	Nr. topo.	Suprafata		Descriere	Cota Parte	Proprietar
			ha	mp			
2	1581	246/b/1/1/2; 246/b/1/2/2; 246/b/2/2; 246/a/1/2; 246/a/2/2/7 246/b/1/1/2; etc. 246/a/2/2/8	-	773 2477	Arabil Arabil	1/1	Pap Stefan
3	1575	246/b/1/1/2; etc. 246/a/2/2/6	-	1750	Arabil	1/1	Mandak Terezia
4	1582	246/b/1/2; 246/b/1/2/2; 246/b/2/2; 246/a/1/2; 246/a/2/2/4 246/b/1/1/2; etc. 246/a/2/2/5	-	975	Arabil	1/1	Nemedi Emeric
			1	9025	Arabil		

B. Situatia dupa dezmembrare, intabulare si rectificare CF

Nr. crt.	Nr. topografic nou	Nr. parcela
19	246/b/1/1/2;246/b/1/2/2;246/b/2/2;246/a/1/2;246/a/2/2/7; 246/b/1/1/2;246/b/1/8;246/b/1/1/2;246/a/2/2/6;246/b/1/1/2; 246/b/1/2/2;246/b/2/2;246/a/1/2;246/a/2/2/4; 246/b/1/1/2;246/a/2/2/5	:/19 16
20		:/20 17
21		:/21 20
22		:/22 21
23		:/23 24
24		:/24 25
25		:/25 28
26		:/26 29
27		:/27 32
28		:/28 33
29		:/29 36
30		:/30 37
31		:/31 tanc septic
32		:/32 41
33		:/33 40

Proiect nr. : 14/2001		Faza: <b>P. U. Z.</b>	Plansa nr. : <b>A 10</b>
Proiect: <b>PLAN URBANISTIC ZONAL</b>		Beneficiar: <b>BERCEA, BALINTONI, PAPP MANDAK, NEMEDI, PURTATOR</b>	
Loc. proiect: <b>Localitatea DUMBRAVITA, jud. TIMIS</b>		Plansa: <b>Situatia topografica NEMEDI -PAPP - MANDAK</b>	
Scara: <b>1:2000</b>		Data: <b>sept.2001</b>	
s.c. PRO ARHI LINE s.r.l.		Scara: <b>1:2000</b>	Data: <b>sept.2001</b>
Sef proiect:	arh. L. Buzulica		
Proiectat:	arh. M. Catana		
Desenat:	arh. F. Blidar		
	arh. F. Blidar		

A. SITUATIA CONFORM CARTII FUNCiare, INAINTE DE DEZMEMBRARE

Nr. crt.	Nr. CF.	Nr. topo.	Suprafata		Descriere	Cota Parte	Proprietar
			ha	mp			
5	1756	246/b/1/2; 246/b/1/2/2; 246/b/2/2; 246/a/1/2; 246/a/2/2/1	1	5767	Arabil	1/2 1/2	Purtator Helmuth Ilie Purtator Daniela
			1	0140	Arabil		
			-	4093	Arabil		

B. Situatia dupa dezmembrare, intabulare si rectificare CF

Nr. crt.	Nr. topografic nou	Nr. parcela
1	246/b/1/2;246/b/1/2/2;246/b/2/2;246/a/1/2; 246/a/2/2/1;246/b/1/1/2; 246/a/2/2/2;246/b/1/1/2;246/a/2/2/3	acces drum
2		42
3		acces drum
4		tanc septic
5		46
6		47
7		50
8		50
9		54
10		55
11		57
12		60
13		61
14		63
15		drum
16		parc
17		drum
18		parc

Proiect nr. : 14/2001		Faza: <b>P. U. Z.</b>		Plansa nr. : <b>A 11</b>	
<b>Proiect: PLAN URBANISTIC ZONAL</b>		<b>Loc. proiect: Localitatea DUMBRAVITA, jud. TIMIS</b>		<b>Beneficiar: BERCEA, BALINTONI,PAPP MANDAK, NEMEDI, PURTATOR</b>	
<b>Plansa:</b>		<b>Situatia topografica PURTATOR HELMUTH-SI SOTIA</b>			
<b>s.c. PRO ARHI LINE s.r.l.</b>		Scara: 1:2000		Data: sept-2001	
		arf. L. Buzulica		arf. M. Catana	
Sef proiect:		arf. F. Bliclar		arf. F. Bliclar	
Proiectat:					
Desenat:					



A. SITUATIA CONFORM CARTII FUNCiare, INAINTE DE DEZMEMBRARE

Nr. crt.	Nr. CF.	Nr. topo.	Suprafata		Descriere	Cota Parte	Proprietar
			ha	mp			
5	1756	246/b/1/2; 246/b/1/2/2; 246/b/2/2; 246/a/1/2; 246/a/2/2/1	1	5767	Arabil	1/2 1/2	Purtator Helmuth Ilie Purtator Daniela
			1	0140	Arabil		
			-	4093	Arabil		

B. Situatia dupa dezmembrare, intabulare si rectificare CF

Nr. crt.	Nr. topografic nou	Nr. parcela
19	246/b/1/2;246/b/1/2/2;246/b/2/2;246/a/1/2; 246/a/2/2/1;246/b/1/1/2; 246/a/2/2/2;246/b/1/1/2;246/a/2/2/3	:/19 62
20		:/20 59
21		:/21 58
22		:/22 56
23		:/23 53
24		:/24 52
25		:/25 49
26		:/26 48
27		:/27 45
28		:/28 tanc septic
29		:/29 44
30		:/30 43

Proiect nr. : 14/2001		Faza: <b>P. U. Z.</b>	Plansa nr. : <b>A 12</b>
Proiect:	<b>PLAN URBANISTIC ZONAL</b>	Situatia topografica <b>PURTATOR HELMUTH- SI SOTIA</b>	
Loc. proiect:	Localitatea DUMBRAVITA, jud. TIMIS		
Beneficiar:	BERCEA, BALINTONI, PAPP MANDAK, NEMEDI, PURTATOR		
Plansa:			
Scara:	1:2000	Data:	sept.2001
Sef proiect:	arh. L. Buzulica		
Proiectat:	arh. M. Catana		
Desenat:	arh. F. Blidar		
	arh. F. Blidar		



s.c. PRO ARHI LINE s.r.l.