

PLAN DE SITUATIE  
Sc. 1:2000

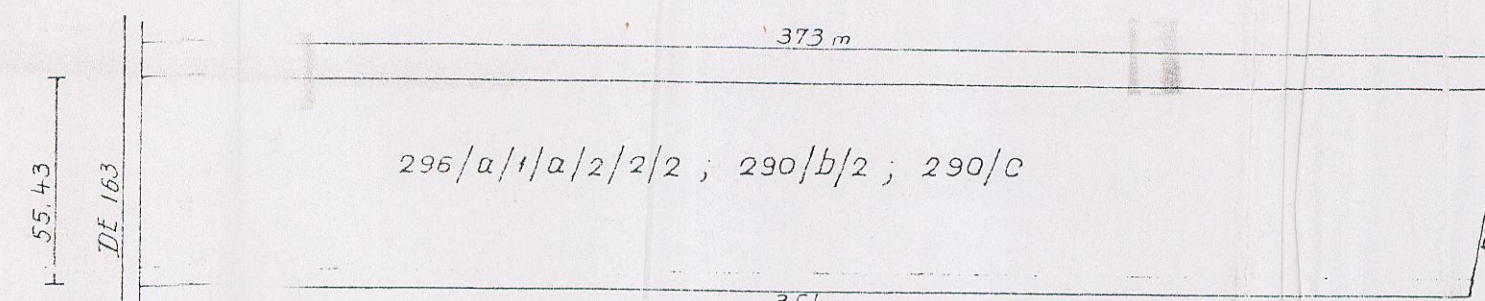

PLAN DE DEZMEMBRARE  
Sc. 1:2000

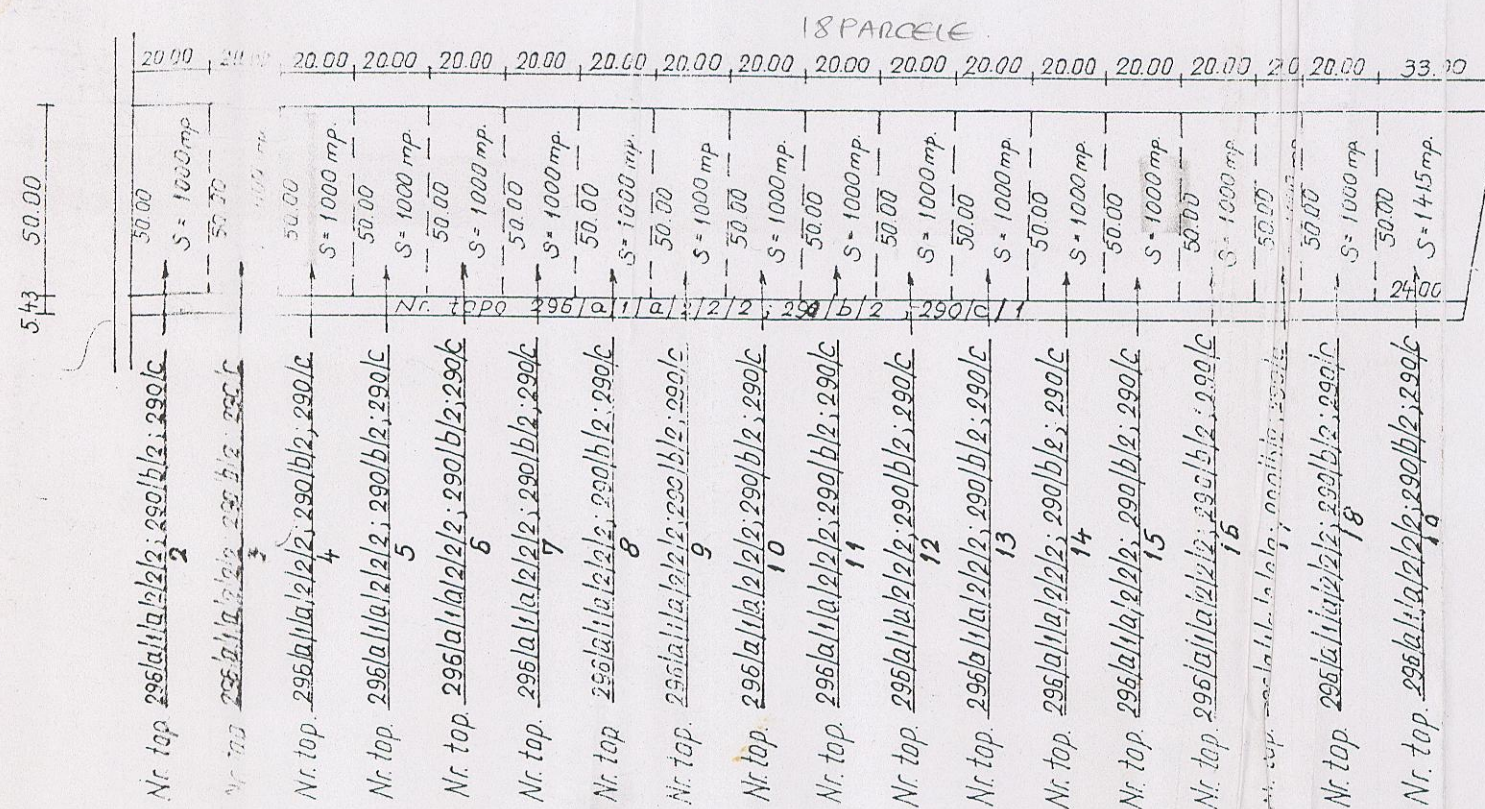

PLAN DE INCADRARE IN ZONA  
Sc. 1:20.000

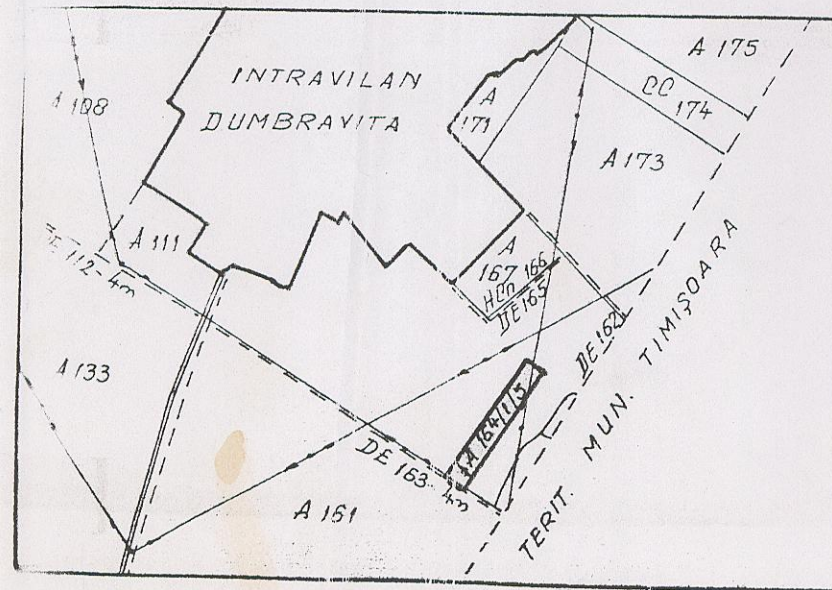

Nr. crt.	Proprietari	Nr. D.F.	Nr. topografic	Date p.	Descrierea imobilului	Suprafata Ha	mp
<b>A. SITUATIA INAINTE DE DEZMEMBRARE</b>							
1.	Simon Eleonora	1678	296/a/1/a/2/2/2; 290/b/2, 290/c	1/1	Arabil-extravilan	2	0400
<b>B. SITUATIA DUPA DEZMEMBRARE</b>							
Simon Eleonora	1678	296/a/1/a/2/2/2; 290/b/2; 290/c	1/1	Drum. acces	0	1985	
	Nou	296/a/1/a/2/2/2; 290/b/2; 290/c	1/1	Arabil-extravilan	0	1000	
	Nou	296/a/1/a/2/2/2; 290/b/2; 290/c	1/1	Arabil-extravilan	0	1000	
	Nou	296/a/1/a/2/2/2; 290/b/2; 290/c	1/1	Arabil-extravilan	0	1000	
	Nou	296/a/1/a/2/2/2; 290/b/2; 290/c	1/1	Arabil-extravilan	0	1000	
	Nou	296/a/1/a/2/2/2; 290/b/2; 290/c	1/1	Arabil-extravilan	0	1000	
	Nou	296/a/1/a/2/2/2; 290/b/2; 290/c	1/1	Arabil-extravilan	0	1000	
	Nou	296/a/1/a/2/2/2; 290/b/2; 290/c	1/1	Arabil-extravilan	0	1000	
	Nou	296/a/1/a/2/2/2; 290/b/2; 290/c	1/1	Arabil-extravilan	0	1000	
	Nou	296/a/1/a/2/2/2; 290/b/2; 290/c	1/1	Arabil-extravilan	0	1000	
	Nou	296/a/1/a/2/2/2; 290/b/2; 290/c	1/1	Arabil-extravilan	0	1000	
	Nou	296/a/1/a/2/2/2; 290/b/2; 290/c	1/1	Arabil-extravilan	0	1000	
	Nou	296/a/1/a/2/2/2; 290/b/2; 290/c	1/1	Arabil-extravilan	0	1000	
	Nou	296/a/1/a/2/2/2; 290/b/2; 290/c	1/1	Arabil-extravilan	0	1000	
	Nou	296/a/1/a/2/2/2; 290/b/2; 290/c	1/1	Arabil-extravilan	0	1000	
	Nou	296/a/1/a/2/2/2; 290/b/2; 290/c	1/1	Arabil-extravilan	0	1000	
	Nou	296/a/1/a/2/2/2; 290/b/2; 290/c	1/1	Arabil-extravilan	0	1000	
	Nou	296/a/1/a/2/2/2; 290/b/2; 290/c	1/1	Arabil-extravilan	0	1000	
	<b>TOTAL</b>						2

SECIUL DE...  
SERVICIUL DE...  
600 -...  
AVIZAT

PLAN DE DEZMEMBRARE  
A NR. TOP. 296/a/1/a/2/2/2;  
290/b/2; 290/c - EXTRAVILAN  
COM. DUMBRAVITA

PLAN DE DEZMEMBRARE  
PLAN DE INCADRARE IN ZONA  
TABEL - SITUATIA JURIDICA

Sc. 1:2000  
1:20000